

MAPLE OVENS

1065 CE COMBI OVEN



MAPLE

RIMASEE CORP.

1500 Grand Concourse Suite 41B,
Bronx, NY 10457
(347) 809 3544 / (646) 919 2500

www.maple-ovens.com
info@maple-ovens.com



1065 CE Combi Oven



CODE: 925913120

Technical features

| | |
|----------------------|--|
| Outside Dimensions: | 33 7/16" L 36 5/8" W 45 1/4" H |
| Space Between Trays: | 3 3/16" |
| Trays: | 10 Trays 18" x 26" |
| Power: | 15 KW - 68 Amps |
| Weight: | 243 lbs |
| Max Temperature: | 518 °F |
| Power Supply: | 230 V ~ 3PH + PE 230 V ~ 1PH + N + PE 50-60 Hz |

Equipment

| | | |
|-----------------------------|--------------------------------|------------------------------|
| Touch screen | 6 Cooking modes | 5 Fan speeds |
| LED lighting | Core probe | HACCP register |
| Pre-heating option | Controlled steam injection (%) | Online collection of recipes |
| Cooling system | Fan inversion system | Multi-timer tray cooking end |
| 10 Phases for cooking | Multipoint probe | Glass opening for cleaning |
| Delayed cooking programming | Error reporting | USB port |

Accessories

Cabinets, Blast chillers, Exhaust & draining, Cleaning & purification, Control tools, Stands & supports, Trays

1065 CE Combi Oven

CODE: 925913120

Spec Drawing - Electrical Supply

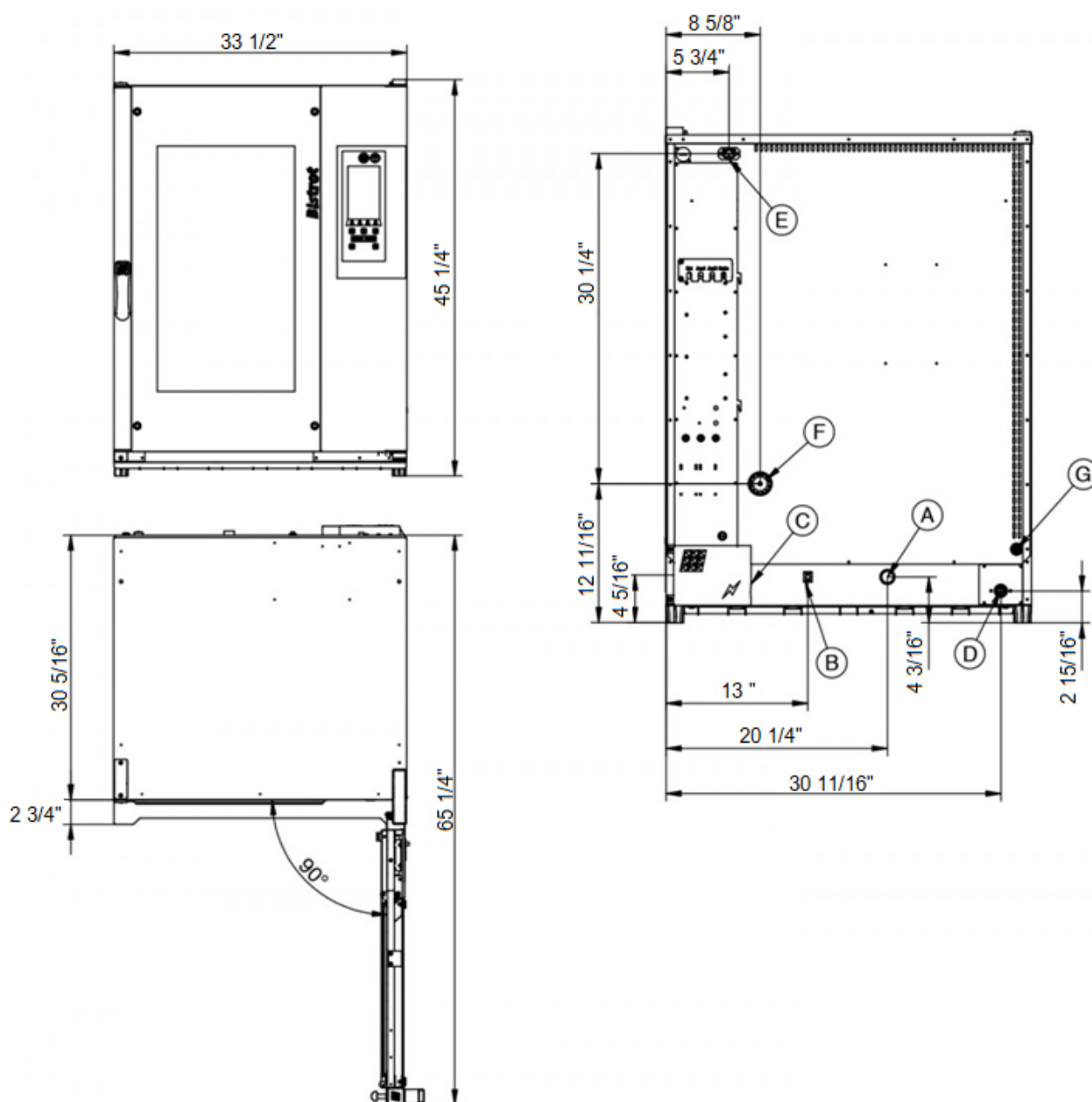

Legend

- A - Drain liquid $\varnothing 30$ mm
- B - Equipotential terminal comb
- C - Electric supply
- D - Water inlet $\frac{3}{4}$ "
- E - Extracting hood supply
- F - Steam exhaust $\varnothing 50$ mm
- G - Inlet for washing kit $\varnothing 8$ mm
- H - Depressurizer $\varnothing 12$ mm



1065 CE Combi Oven

CODE: 925913120

Connections

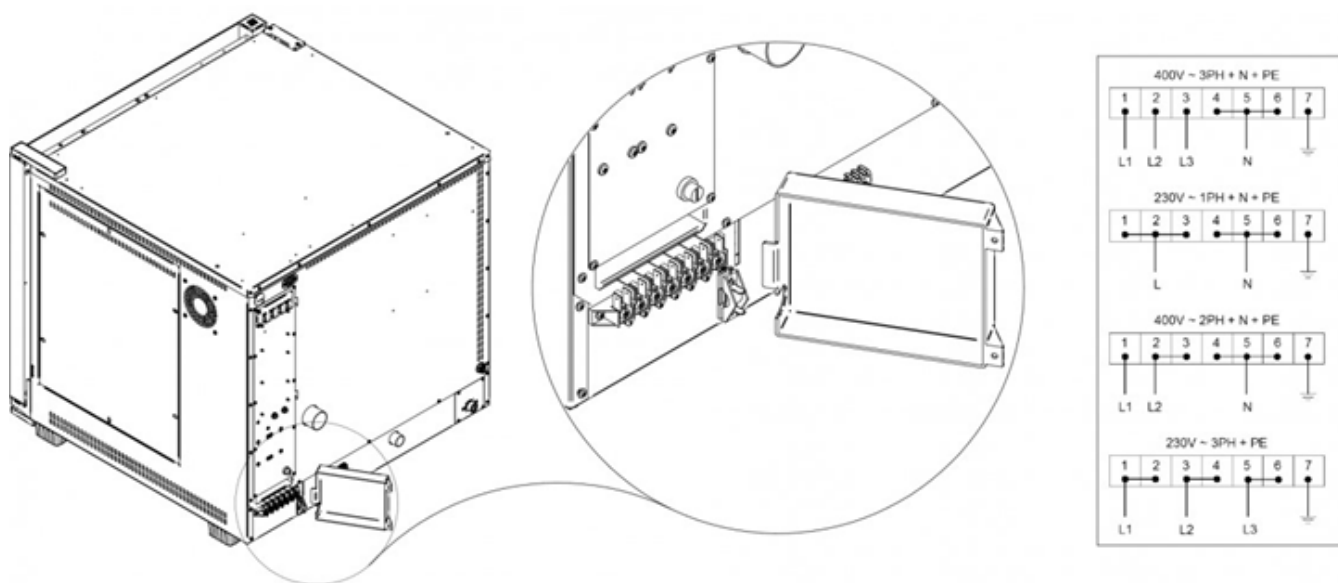

Packaging

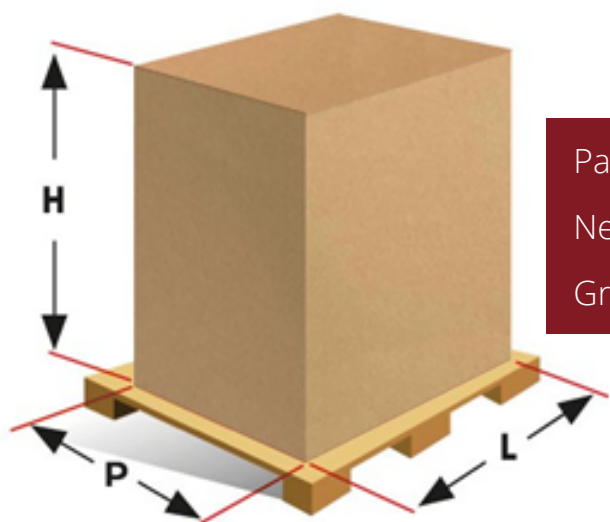

Packaging Size: 36 1/4" L 39 3/8" P 51 3/16" H

Net Weight: 267 lbs

Gross Weight: 289 lbs

1500 Grand Concourse Suite 41B,
Bronx, NY 10457
(347) 809 3544 / (646) 919 2500



www.maple-ovens.com
info@maple-ovens.com